

50Gbps transfer bandwidth
provided by CXP-12 Quad

67MP resolution

CoaXPress 2.0 | EX Series

High-speed Interface High-end Camera

Mounted with e2v global shutter CMOS sensor



CoaXPress

NEW

EX670AMG-X

CXP-12 Quad | EX series | 60×60×80mm | 280g

67
MP

64.5
fps

B/W

Bandwidth
50G

Feature

50Gbps transfer bandwidth provided by CoaXPress 2.0 CXP-12 Quad

- Bandwidth ten times wider than USB 3.1 Gen1 (USB 3.0)
- Bandwidth seven times wider than the Camera Link Full configuration

The 67Mp resolution and the electronic global shutter make it possible to capture fast moving subjects sharply with minimal motion blur.

The optional F or M42 mount adapter makes it possible to use various lenses, including those for single-lens reflex cameras.

Teli Core Technology contributes to the enhancement of the response speed of camera systems.

The EX Series can be connected to various image processing systems with a flexible and reliable long coaxial cable.



F-mount / M42-mount
conversion adapter
(Optional)

Toshiba Teli Corporation

<https://www.toshiba-teli.co.jp/en/>



Specifications

B/W or COLOR	B/W
Pixels	67M
Model	EX670AMG-X
Interface	CoaXPress 2.0
Imager	CMOS image sensor
Imager model	EV2567MB
Resolution	8,192(H) x 8,192(V)
Frame rate	64.5fps (CXP-12 Quad, Mono 8bit), 31.6fps (CXP-6 Quad, Mono 8bit), 15.8fps (CXP-12, Mono 8bit), 8fps (CXP-6, Mono 8bit)
Pixel size	2.5μm x 2.5μm
Scanning area	20.48mm(H) x 20.48mm(V)
Image size	1.8 type (APS-C)
Aspect ratio	1:1
Scanning	Progressive
Electronic shutter method	Global shutter
Random Trigger Shutter Type	External Trigger / Software Trigger / Link Trigger
Random Trigger Shutter Mode	Edge / Level / Bulk (255 times)
Sequential shutter	-
Exposure Time	MANUAL : 10μs to 1s Random Trigger Shutter : 10μs to 1s (Edge or Bulk mode), 200μs to Trigger width (Level mode)
Synchronization System	Internal
Optical glass/filter	Dust-proof glass
Sensitivity	2,500 lx (F8, 1/66.7s)
Minimum illuminance	1 lx (F1.4, Gain : +36dB, Video level : 50%)
Gain	MANUAL : 0 to +36dB
Black Level	-25% to +25%
Gamma / LUT	γ=1.0 to 0.45 / In 12bit, Out 12bit
Image Output Format	Mono12, Mono10, Mono8
Readout Mode	All pixel, ROI, Binning, Subsampling, Mirroring, Flip
External trigger input	Low: 0 to 0.5V, High: 2 to 24.0V High active / Low active, Pulse width: 200μs (minimum)
Power supply	PoCXP / DC+24V (18.5V to 26V) (HIROSE connector)
Power consumption	13W (All pixel, CXP-12 Quad output)
Lens mount	Mountless (Φ50 H7)
Mount adapter option	F-mount / M42-mount conversion adapter
External dimension	60(W) x 60(H) x 80(D) mm (Not including protruding parts)
Mass	280g
Operation temperature	0 °C to 40 °C (below 60 °C on cabinet surface)
Operation humidity	10% to 90% (no condensation)
Conformity	CE, FCC, RoHS, WEEE, CoaXPress 2.0, GenICam, IIDC2

Wider shooting field of view with high resolution of 67MP

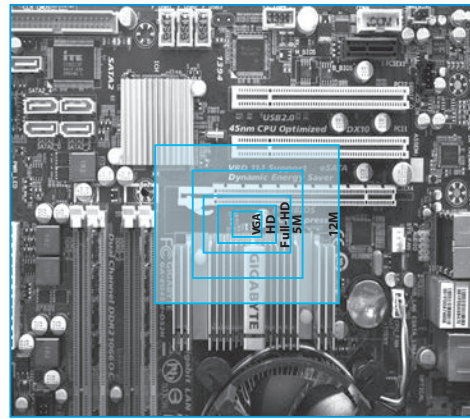

- VGA (640x480)
- HD (1,280x720)
- Full-HD (1,920x1,080)
- 5M (2,448x2,048)
- 12M (4,000x3,000)
- 67M (8,192x8,192)

67M (8,192x8,192)

* The above image is the result of software simulation.

50Gbps transfer bandwidth provided by CoaXPress 2.0 CXP-12 Quad

Comparison of high-speed interface

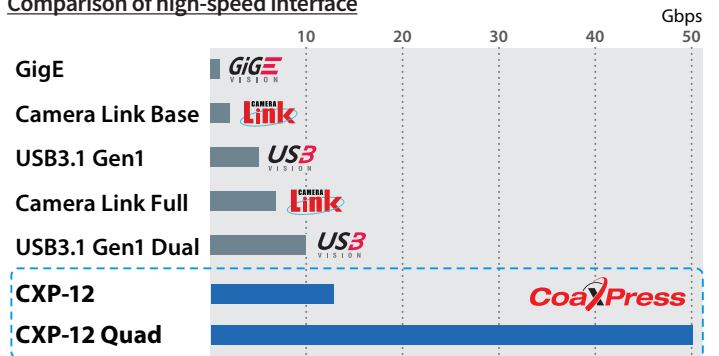

* These are the data transfer bands of each interface and are different from the video data transfer bands.

TeliCamSDK

- Varieties of functions for easy programming
- Easy to capture image
- GEN<i>i>CAM available
- Abundant sample code
- Easy to understand manuals
- Unified SDK for USB3, GigE & CXP
- Supports Python library (pytelicam) *3

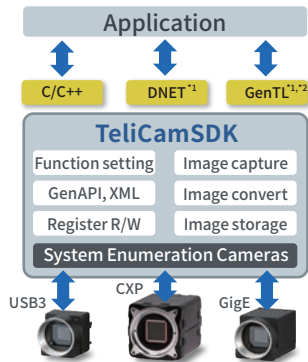

OS / Distribution	Windows			Linux				ARM
	7 SP2	8.1	10	Ubuntu 16.04 LTS amd64	Ubuntu 18.04 LTS amd64	Ubuntu 20.04 LTS amd64	CentOS 8.3 amd64	
Support	✓	✓	✓	✓	✓	✓	✓	✓

TeliCamSDK for Linux supported ARM architectures. - Jetson TX2 / Jetson nano / Raspberry pi 4 *5

*1: for Windows / *2: Supported USB and CXP / *3: Compatible with TeliCamSDK v4.0.0.1 or later / *4: Please contact us for other OS and distributions. / *5: With a GigE camera, image might be missed depending on PC specifications.

Outline drawing

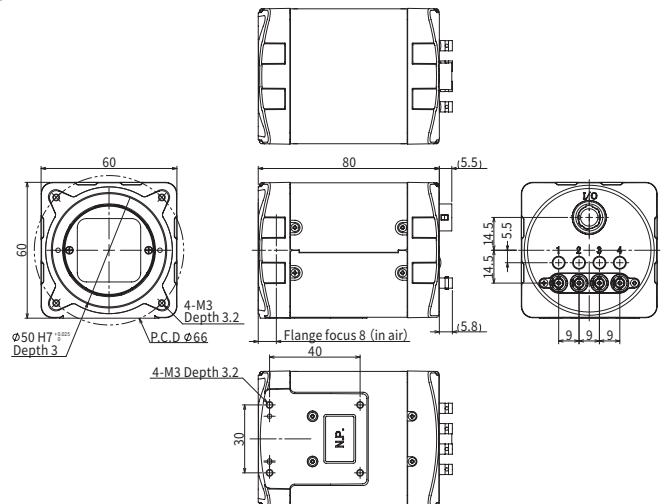

Notes on Safety

- Before using this product, please read "Operation Manual" carefully in order to use this product safely and correctly.
- If this product should be used in the extraordinary conditions or environments, or if you have any questions or problems, please contact our sales division.

Toshiba Teli Corporation

<https://www.toshiba-teli.co.jp/en/>



- The information of this catalog is subject to change without notice.
- Company name, product name or logo might be trademark or registered trademark of each company or organization.
- We shall be exempted from taking responsibility and held harmless for damage or losses incurred by the user.

The information of this catalog is current as of September 2021.

4000-0385-2109