





## ADIMEC-1000m



Adimec is a prominent international supplier of high performance video cameras for use in machine vision, medical and military applications.

Adimec targets OEM companies with a leading position in their market that consider performance and reliability of the product and the supplier to be critically important.

Adimec has over ten years experience translating demanding customer requirements into innovative, reliable and high performance camera products.

Our mission is to provide superior camera products to companies around the world that view image quality and product reliability as essential to their applications.

### FEATURES

- 1004 x 1004 with 7.4  $\mu$ m square pixels
- Interline CCD with microlenses with high Blue and NIR response
- Very stable and accurate sensor mounting
- High frame rate
- Excellent channel matching characteristics
- Continuous or asynchronous operation
- Partial scan
- Built-in test signal generator
- Camera Link interface
- Small outline & low power consumption
- High product reliability through rugged design

### APPLICATIONS

- Semiconductor inspection
- Electronics manufacturing
- 2D & 3D metrology

### SPECIFICATIONS

Resolution, pixel size	1004 x 1004, 7.4 $\mu$ m square pixels
Frame rate @ full resolution	Adimec-1000m/S, up to 30 progressive fps via a single tap output Adimec-1000m/D, up to 50 progressive fps via dual tap
Partial scan	120 fps at 128 x 1004 (max speed at min. size)
Sensitivity @ 33 ms	1x Gain 5.5 Lux
100% video	8x Gain 0.69 Lux
Spectral Response	350 nm 30%, 500 nm 44%, 700 nm 21%
Dynamic range	> 60 dB
Gain range	1, 2, 4 or 8 times
MTF	50% contrast @ 67 lp/mm (limiting resolution)
Power input range, dissipation	< 5 W @10.5 to 14 Vdc input
Data format (single/dual channel, 8 & 10 bit, 40 MHz)	CameraLink, Base configuration@CameraLink spec 1.0
Lens mount	Adjustable C- mount, other mounts on request
Size	45 mm x 45 mm x 75 mm
Weight	185 grams
Operating temperature range	-10°C to + 40°C
Shock	10 g, half sine shape, 6-10 ms duration
Vibration	3 g, sinusoidal vibration sweeps 5-150 Hz
Compliance CE/UL	CE compliant

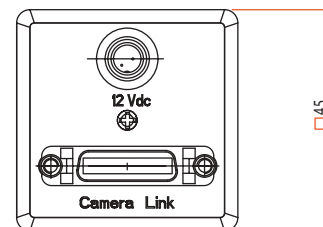
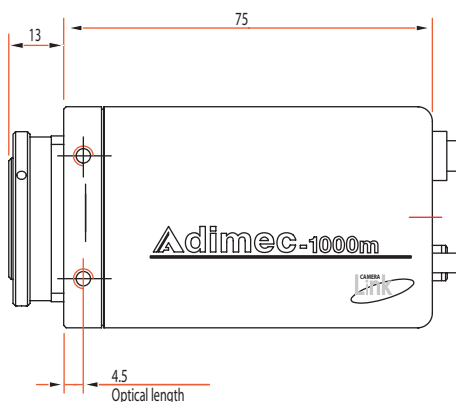
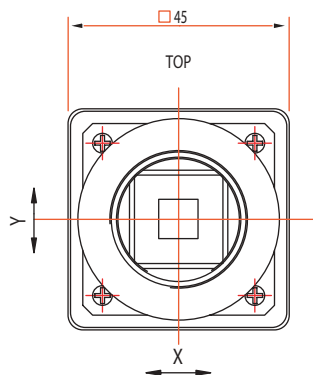

### ADIMEC:

Adimec is a leading worldwide supplier of high performance, innovative, and reliable camera products for use in:

- Machine Vision
- Medical Imaging
- Military Targeting and Observation

Adimec's mission is to serve leading OEM's around the world who view quality and reliability as essential to their success.

Contact us today to find out why top corporations rely on Adimec.